



NOISELESS POWER



THE BLADELESS VORTEX CEILING FAN THAT VENTILATES THE ENTIRE ROOM



LED lighting (warm/cool) optional

7 REASONS TO CHOOSE A BLADELESS FAN

INSPIRED BY NIKOLA TESLA'S BLADELESS TURBINE



Vortex Effect



Quiet



Ecological



Economical

- 1** | The Exhale fan produces an **almost imperceptible** noise even at maximum speed, reaching a sound volume of between 30 and 40 decibels.
- 2** | The Exhale fan is thin (6 inches/18 cms). Its absence of blades considerably reduces the injury risk. Hence it is a great solution for low ceilings.
- 3** | The fan stirs the air in the whole room while consuming very little energy.
- 4** | The Exhale fan helps you save money thanks to its patented technology which combines energy efficiency and constant temperature conditions, **perfectly complementing your air conditioning or heating systems.**
Energy savings of up to 38% *USA 2013 Study*
- 5** | The Exhale fan is calming. Even at high speed, **it doesn't blow things around the room**, papers aren't sent flying, so you can relax in peace!
- 6** | The Exhale fan is stylish. Its spherical shape and sleek line, with no visible screws, **fit perfectly into any interior.**
- 7** | The Exhale fan offers an **alternative to air conditioning** and the traditional ceiling fans.

TOTAL ROOM VENTILATION USING THE VORTEX EFFECT



The fan's Vortex effect

The Typhoon wind vanes (removable) are incorporated between the fan blades and increase ventilation performance by 25 to 40%. The fan runs more slowly and consumes even less energy

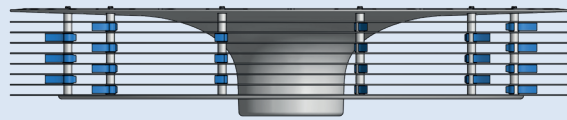

Exhale Fan with Typhoon Wind Vanes

THE VORTEX EFFECT, A HIGHLY EFFECTIVE PATENTED INNOVATION

The Exhale fan alone is able to achieve a unique VORTEX flow by drawing air from below and returning it in a 360-degree direction for total ventilation throughout the room (1 Exhale fan recommended per 50m²).

Thanks to its high-performance motor and its efficient design, the airflow rate (volume of displaced air) at high speed is 115 m³/minute (i.e. 115 815 litres per minute). Besides its technical features, what really sets the Exhale fan apart is the Vortex flow created. The airflow increases as the fan is running to **purify the air and stabilise the temperature in the room.**

PATENTED INNOVATIVE TECHNOLOGY

The innovative technology lies in the **360 degree Vortex airflow movement that ensures total ventilation of the room.** The multi-directional airflow uniformly ventilates the room and produces an exceptional feeling of well-being for all its occupants

EVERY DETAIL MATTERS

- **Direct current for energy efficiency:** we have developed an exclusive DC motor to match maximum rotational speed (more than 300 rpm) with optimum efficiency. The DC motors are eco-friendly compared to their AC equivalents. They consume up to 80% less electricity!
- **A motor with an aeronautics-inspired design:** our motor was specially developed with a turbine engineer from the aeronautics industry. It operates on the same principle as an aircraft reactor. Its high-tech design ensures that air flows smoothly through our ceiling fan.
- **Discs that create a 360° Vortex airflow:** the air molecules are forced outwards by centrifugal force. As one molecule is ejected, another enters through the centre of the fan in a vortex pattern to take its place. This 360-degree movement of the air allows the Exhale fan to gradually turn a stale environment into a place of total comfort in all seasons!
- **Outstanding finish:** we wanted clean lines and a neat design so that no screws or nuts are visible from any angle. The result is a uniquely designed and efficient fan.
- **LED lighting (optional):** this ceiling fan is available with or without LED lighting (2 models).

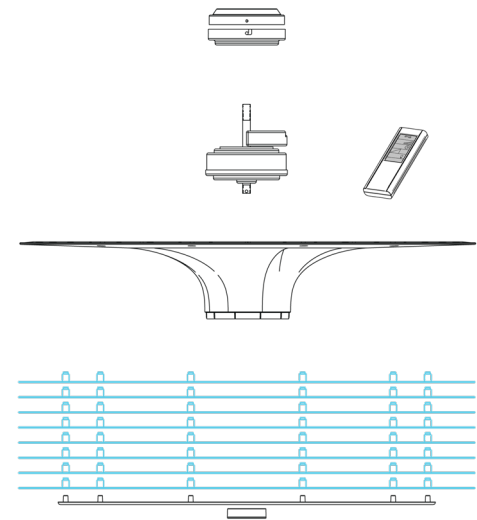

Breakdown of the Exhale Fan

TECHNICAL SPECIFICATIONS

Dimensions

Height 18 cm - Diameter 86.4 cm

Weight: 11,4 kg

Colour: white

Remote control: with 6 speeds

Sound volumes: from 33-35 dB to 40-45 dB

Air Speed : 4.38 m/s

Warranty: Lifetime for the fan, 5 years for the motor.

Price: 690€ (without LEDS), 699€ (with LEDS), VAT included

ENERGY CONSUMPTION & NOISE

Level 1: 4 Watts, 120 RPM, 27 dB

Level 2: 6 Watts, 158 RPM, 31.5 dB

Level 3: 9 Watts, 198 RPM, 37.5 dB

Level 4: 16 Watts, 236 RPM, 38.1 dB

Level 5: 36 Watts, 274 RPM, 38.7 dB

Level 6: 50 Watts, 312 RPM, 40 dB

Exhale EUROPE
La Noria, 806 route d'Antibes
06410 BIOT, France
+33 (0)4 92 38 96 50

contact@exhale-europe.com
www.exhale-europe.com

